

18

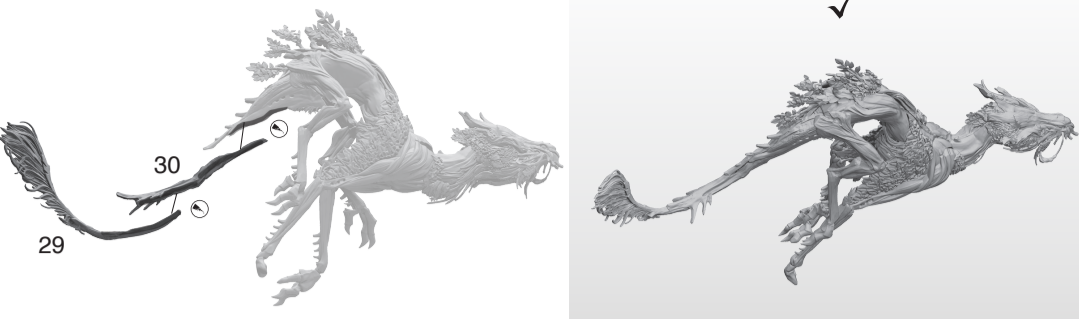

19

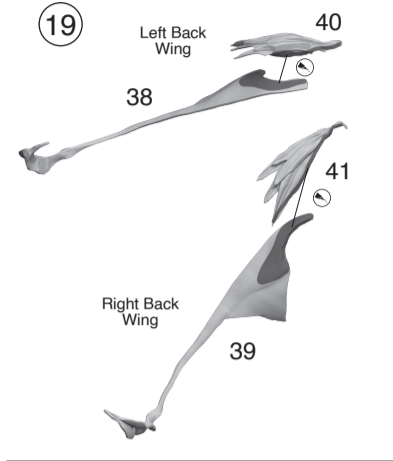

20

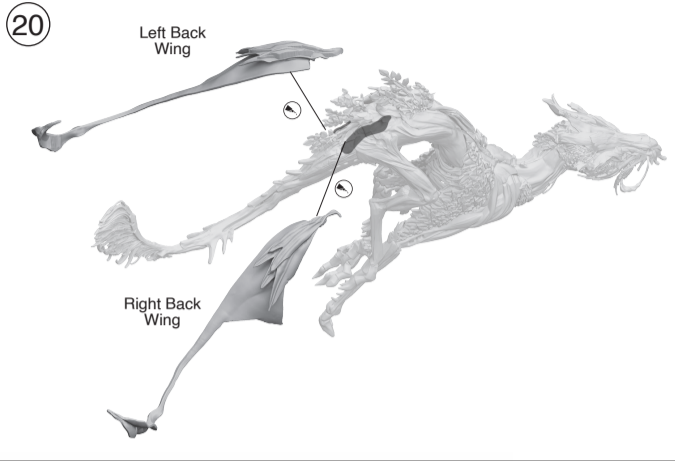

23

Pay close attention to contact points A and B when attaching the model to the scenic base. Proper placement is essential to ensure a secure fit. Always use plastic glue, as it creates a stronger bond.

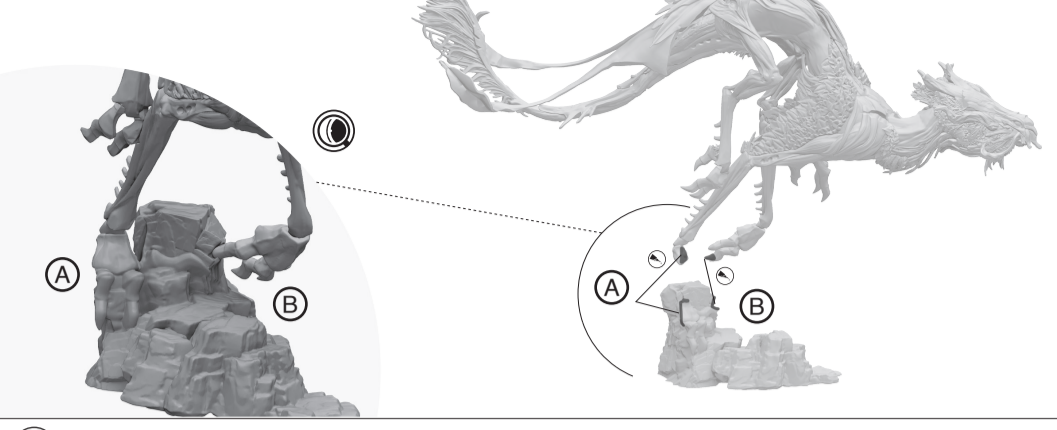

24

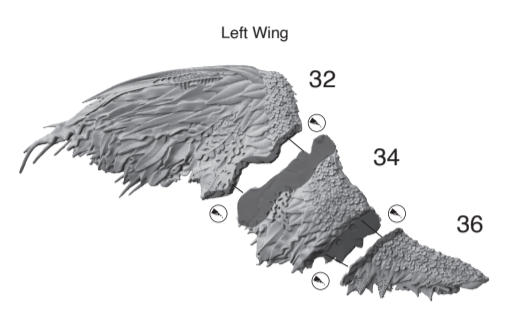
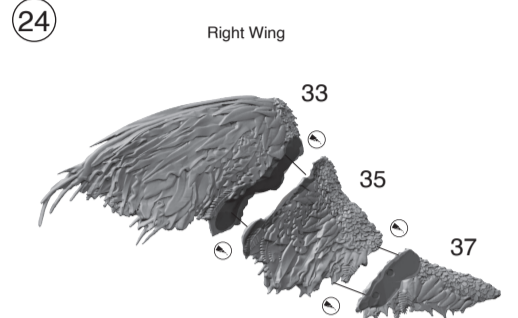

25

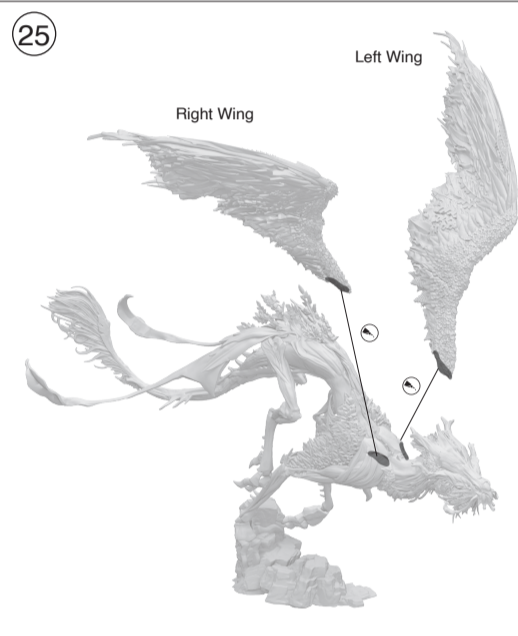

Scenic Base

21

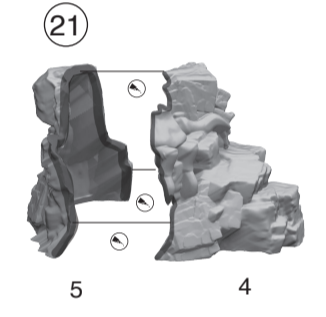

22

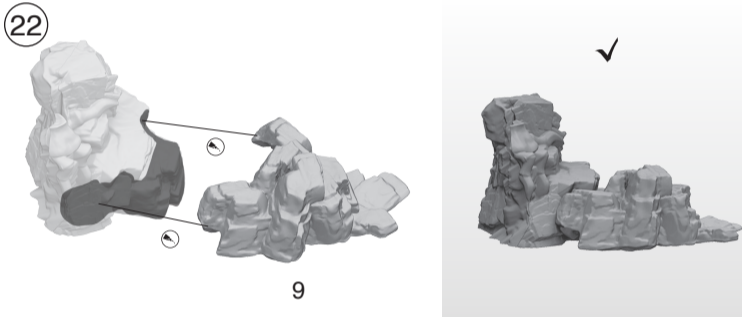

When attaching the completed model to the Monster Base, be sure to position it slightly farther back to maintain its center of balance and prevent it from tipping forward.

Coill Draic



Scoth Draic



Coill Draic / Scotth Draic Assembly Instructions

READ THIS FIRST

**BEFORE ASSEMBLING YOUR MODEL KIT PLEASE READ THROUGH THE INSTRUCTIONS IN THIS BOOKLET CAREFULLY.** A pair of plastic cutters is required to remove the plastic components in this kit from their frame. We advise to carefully scrape mould lines using a hobby knife. To assemble your model you will need plastic glue for plastic parts or super glue for resin parts.

SYMBOL EXPLANATION

- ! Special Instruction - Please read
- ✗ Do not glue the components
- ↻ Rotate part
- ⚙ Variant assembly
- 🔍 Detail view
- 🔪 Glue the component
- ✓ Stage complete
- 🔁 Repeat process
- 🌀 Magnet Slot

You will need:

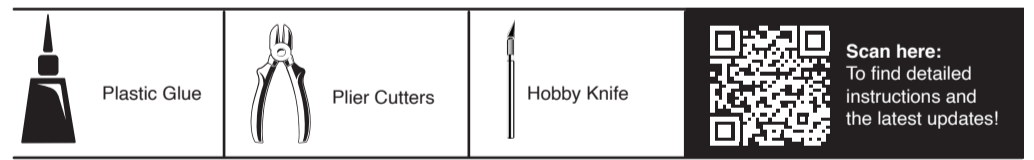

What you get:

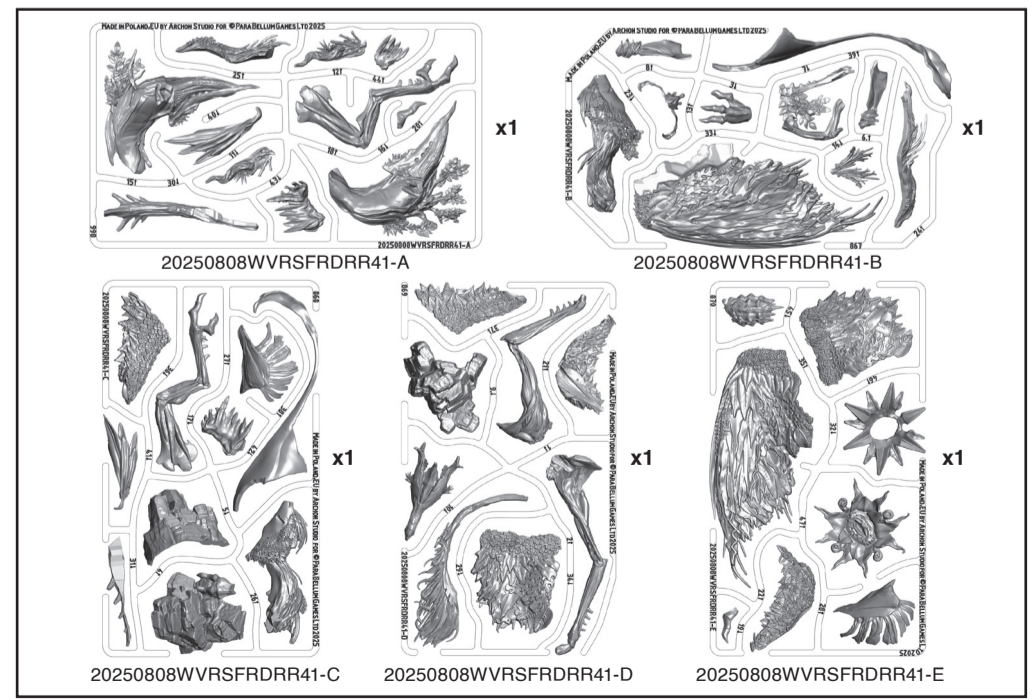

! Make sure to dry fit parts before gluing.

Customizability:

- ◆ No interchangeability.

Coill Draic / Scoth Draic

Body Base

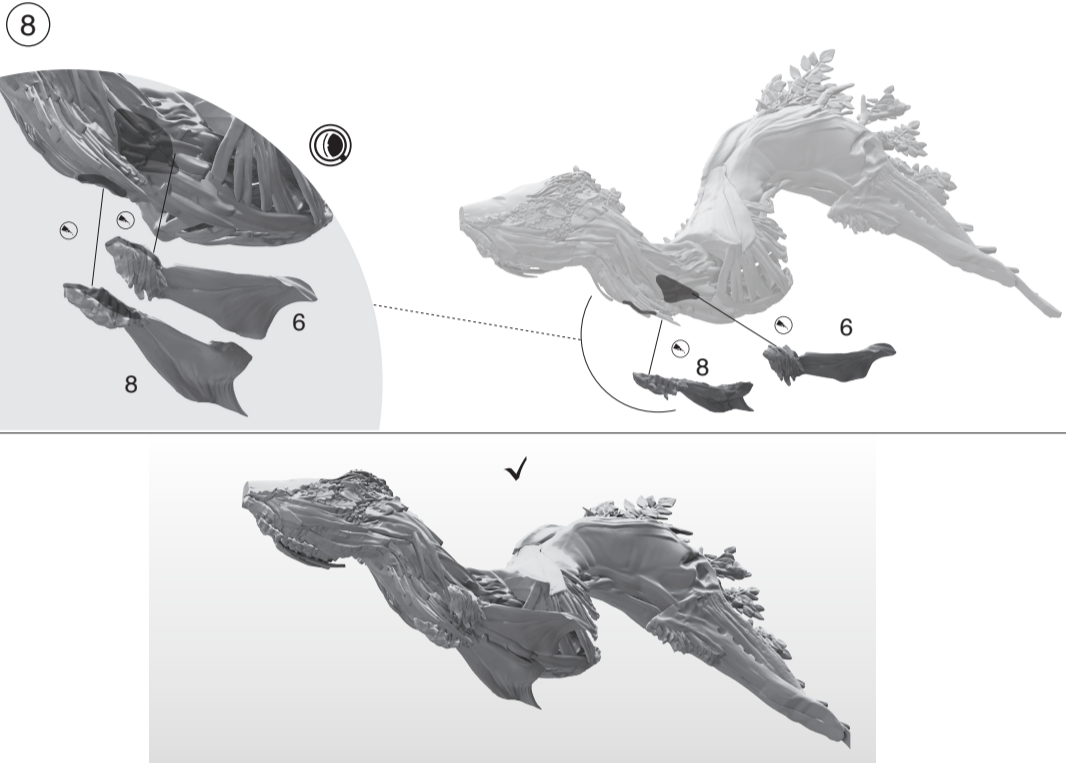
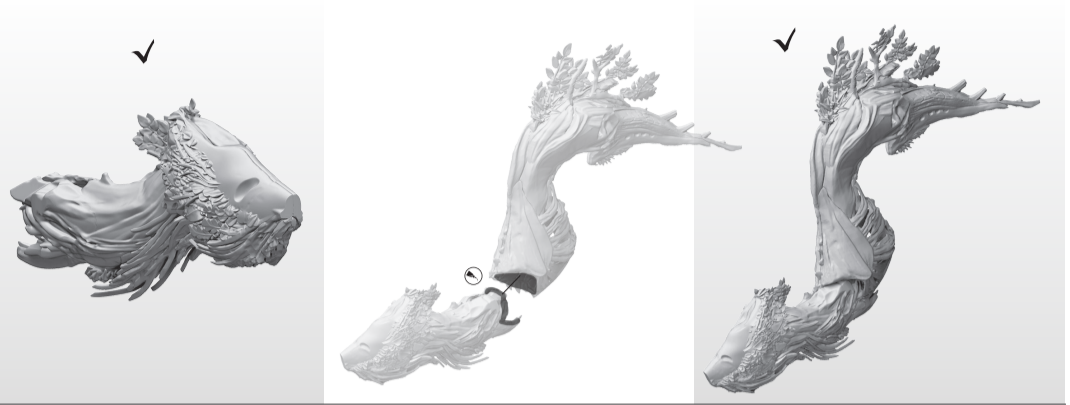
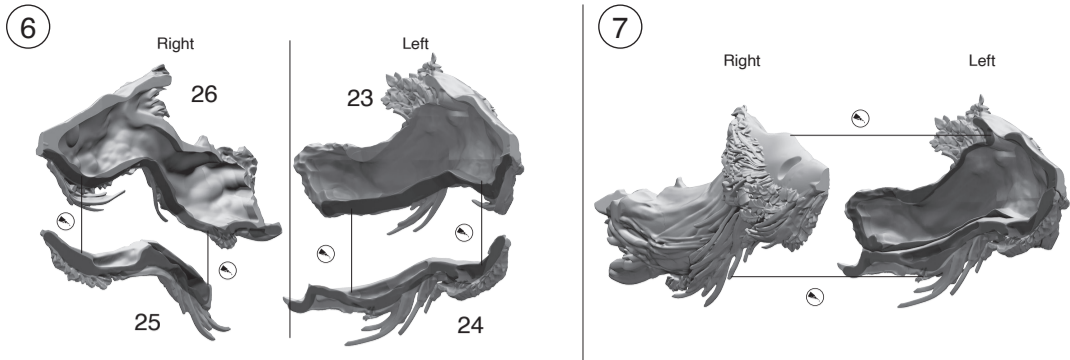
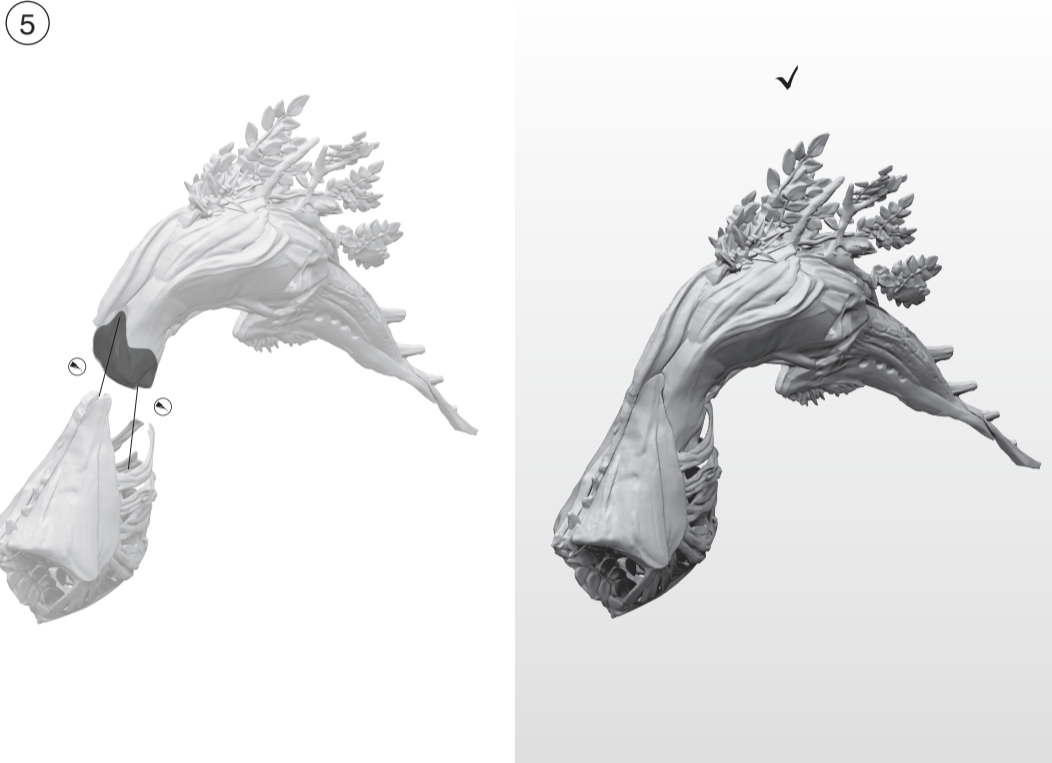
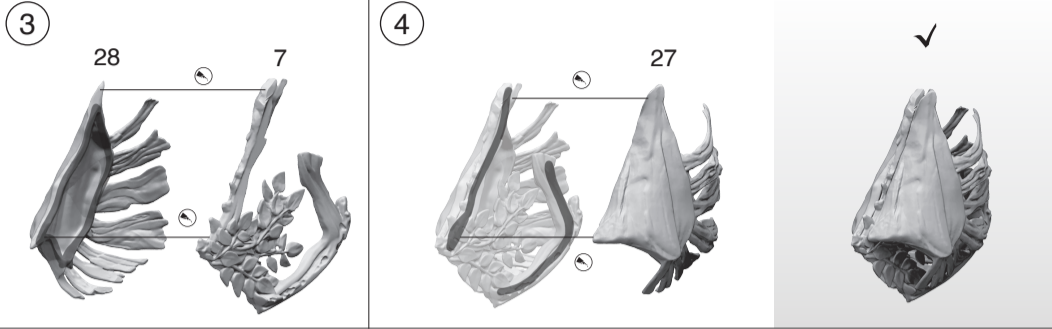
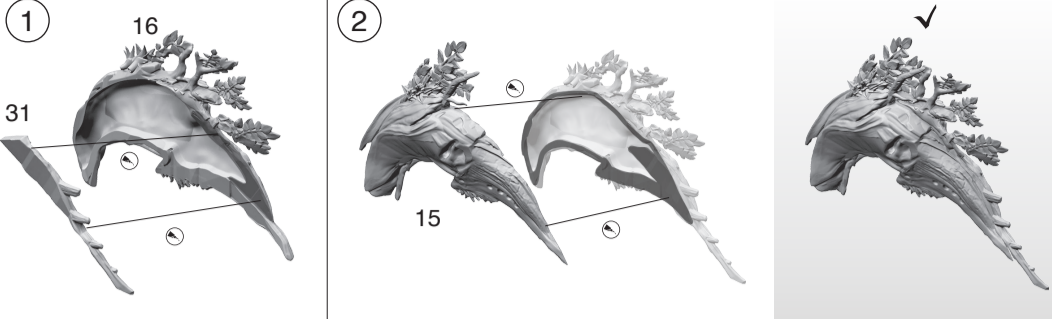

Legs

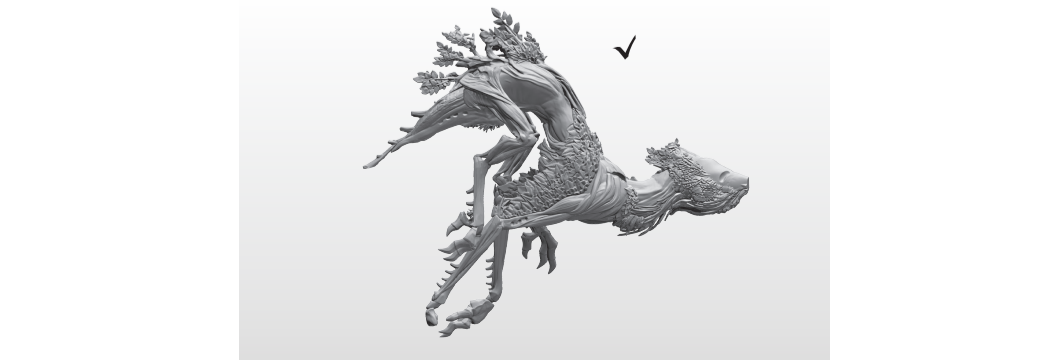
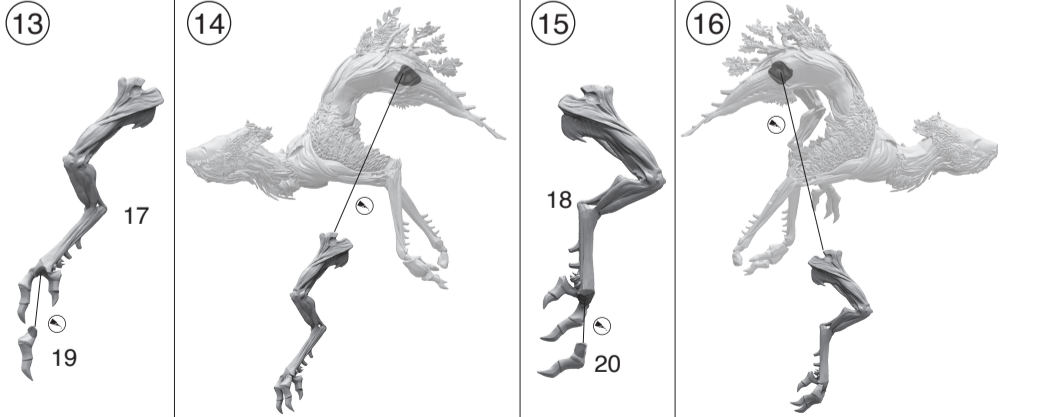
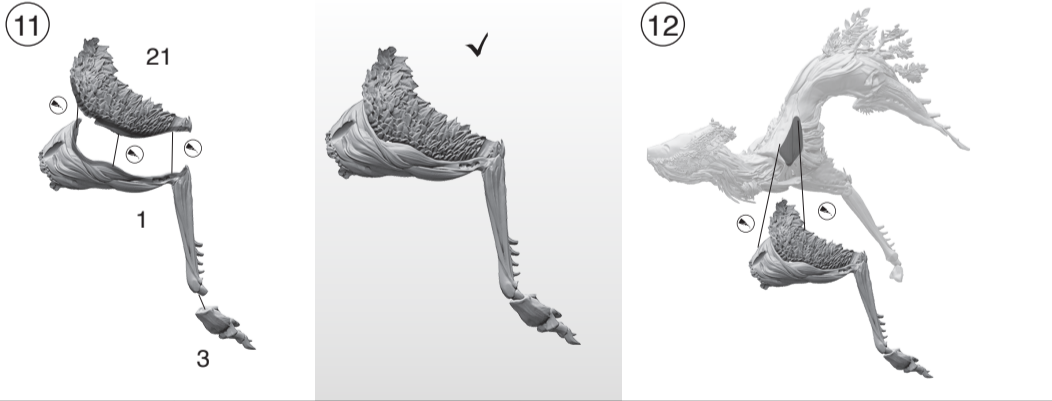
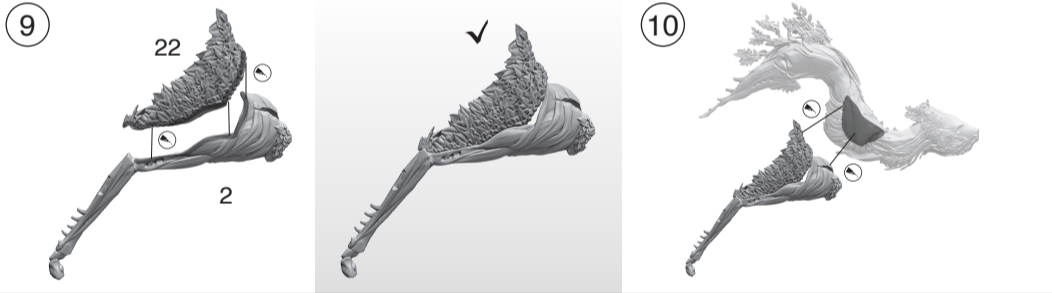

Head Variations

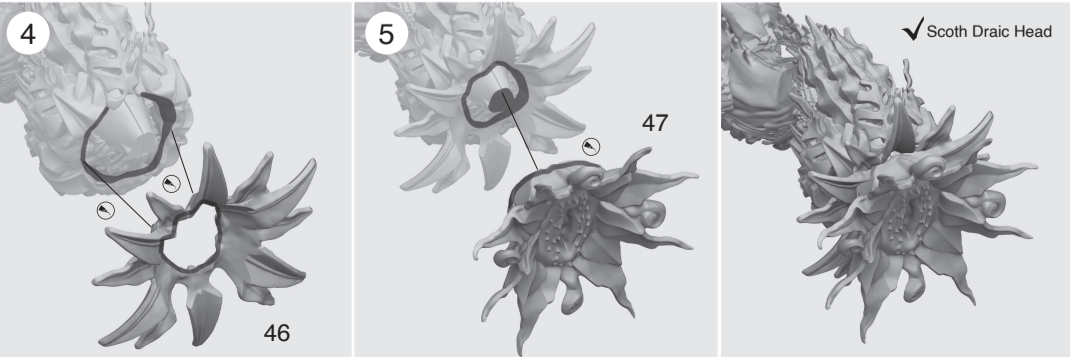
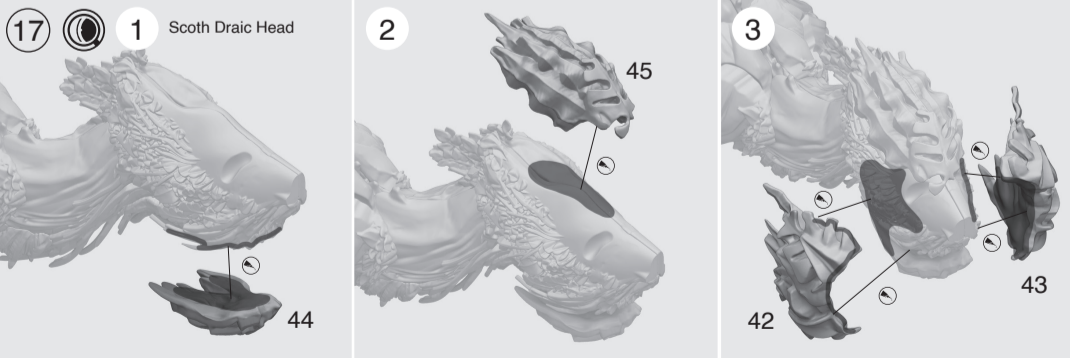
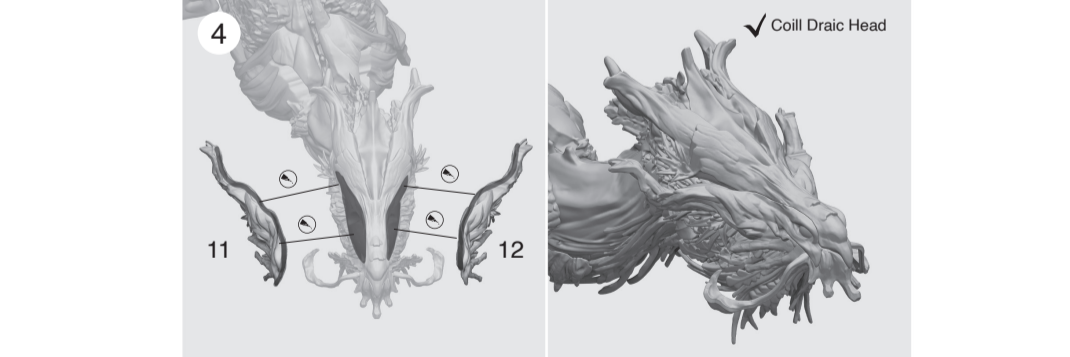
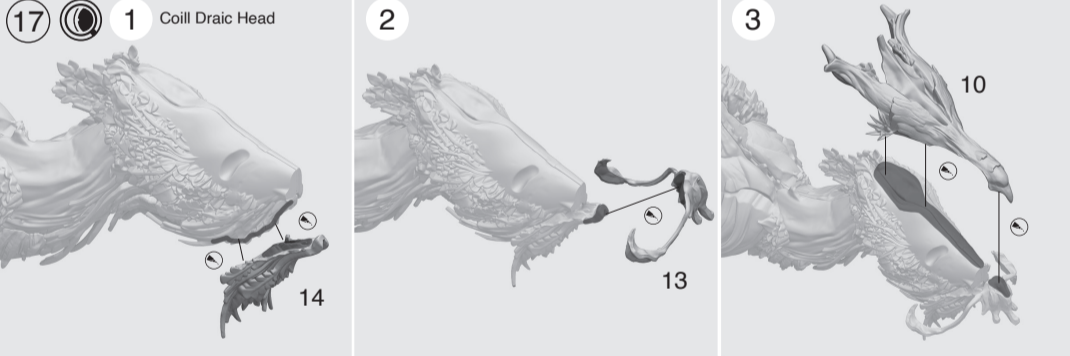

# Coill Draic / Scoth Draic Additional Assembly Tips

## READ THIS FIRST

This document provides a few extra tips to help you assemble this beautiful model! Remember to use plastic glue throughout the process, and allow each section to cure completely before moving on to the next step.

1 Here's another look at how part 31 attaches to part 16.

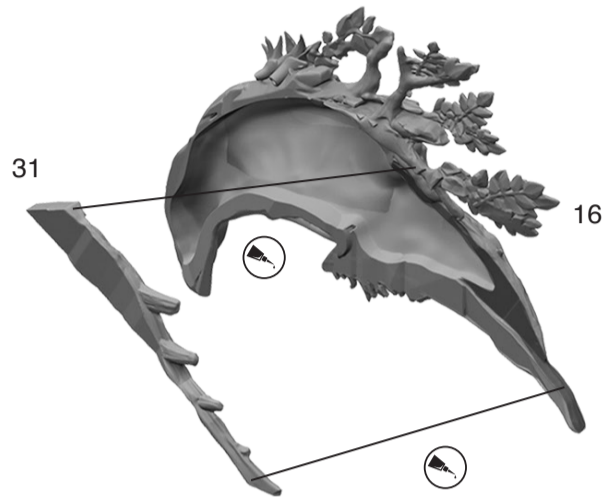

20 Here's a closer look at how the Right and Left Back Wings attach to the Draic's body. Pay close attention to how the Right Back Wing's fang naturally follows the curve of the body. On the left side, the attachment point for the Left Back Wing is located at the base of the fang.

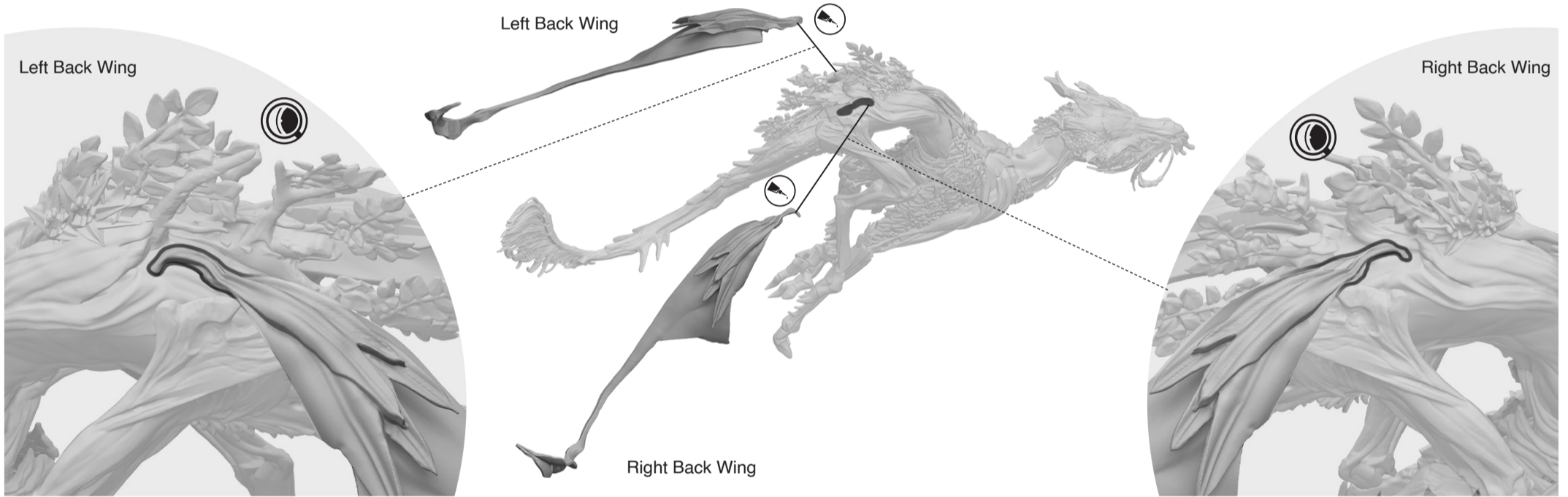

24 Before moving on to assemble the wings, make sure the model is securely attached to the base and has cured overnight. Plastic glue is strong enough to support the weight of the model; however, the bonds it forms need time to fully set.

It's also a good idea - though not strictly necessary - to use the hollow scenic rocks beneath the model to conceal a small weight. A pebble, coin, bead, or any similar object you have on hand can help shift the model's center of gravity backward and prevent it from tipping forward.

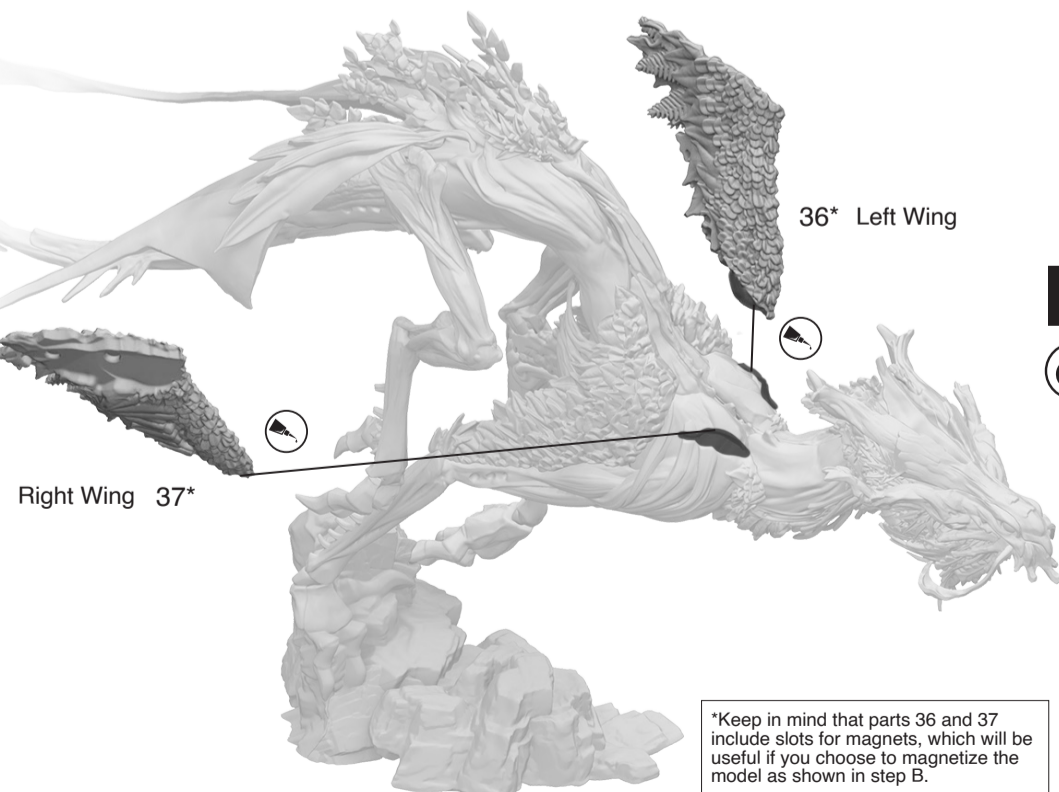

\*Keep in mind that parts 36 and 37 include slots for magnets, which will be useful if you choose to magnetize the model as shown in step B.

A If you'd like to fully assemble the Draic without using magnets, attach each section of the wing separately and allow it to cure completely before moving on to the next part. Part 35 attaches to the body, and part 33 then connects to part 35. Similarly, part 34 attaches to the body, which in turn connects to part 32. By letting the glue cure between each step, you ensure that each bond is strong enough to support not only the weight of the current piece but also the next piece added on top.

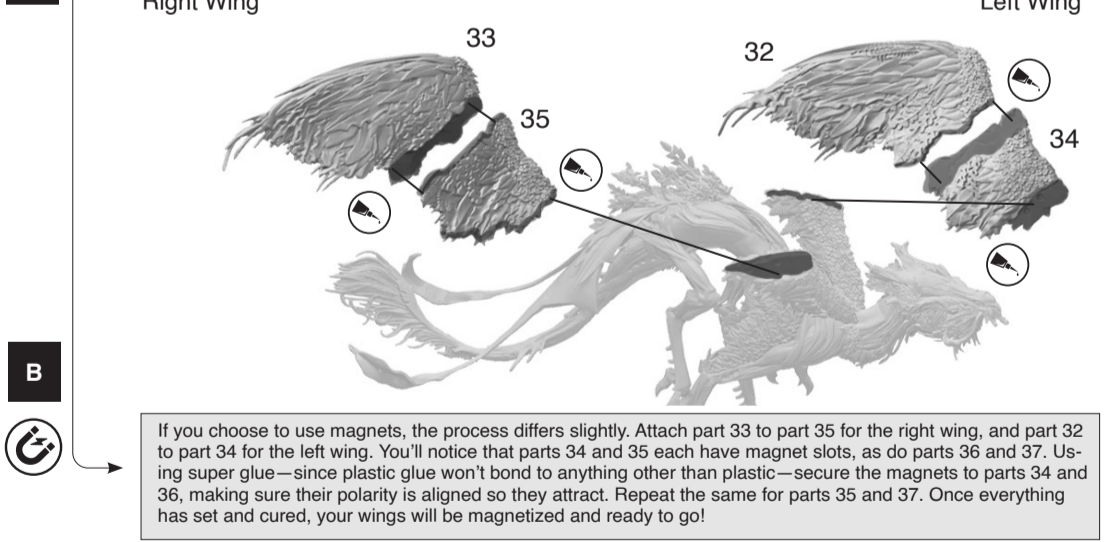

B If you choose to use magnets, the process differs slightly. Attach part 33 to part 35 for the right wing, and part 32 to part 34 for the left wing. You'll notice that parts 34 and 35 each have magnet slots, as do parts 36 and 37. Using super glue—since plastic glue won't bond to anything other than plastic—secure the magnets to parts 34 and 36, making sure their polarity is aligned so they attract. Repeat the same for parts 35 and 37. Once everything has set and cured, your wings will be magnetized and ready to go!

