

7

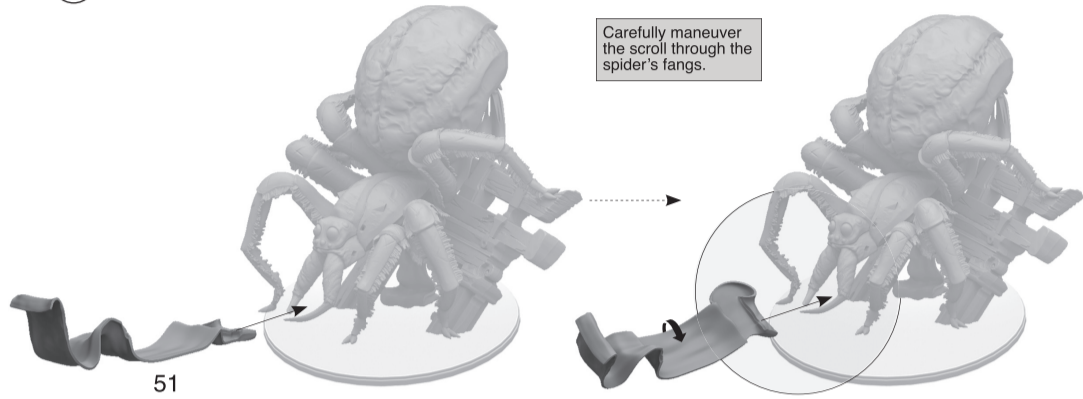

51

8

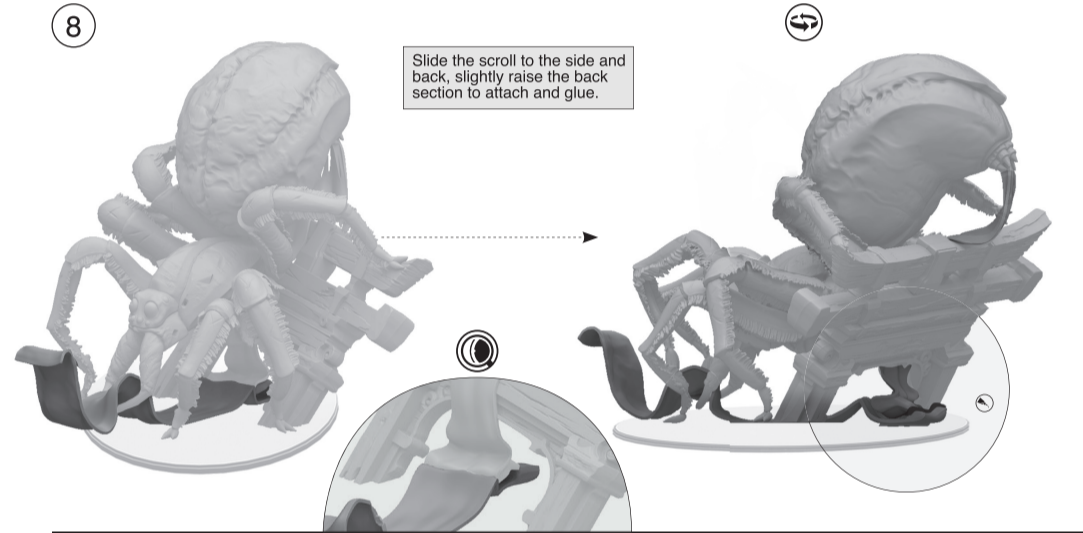

✓ Jorogumo Mahotsu



✓ Jorogumo Geisha



9

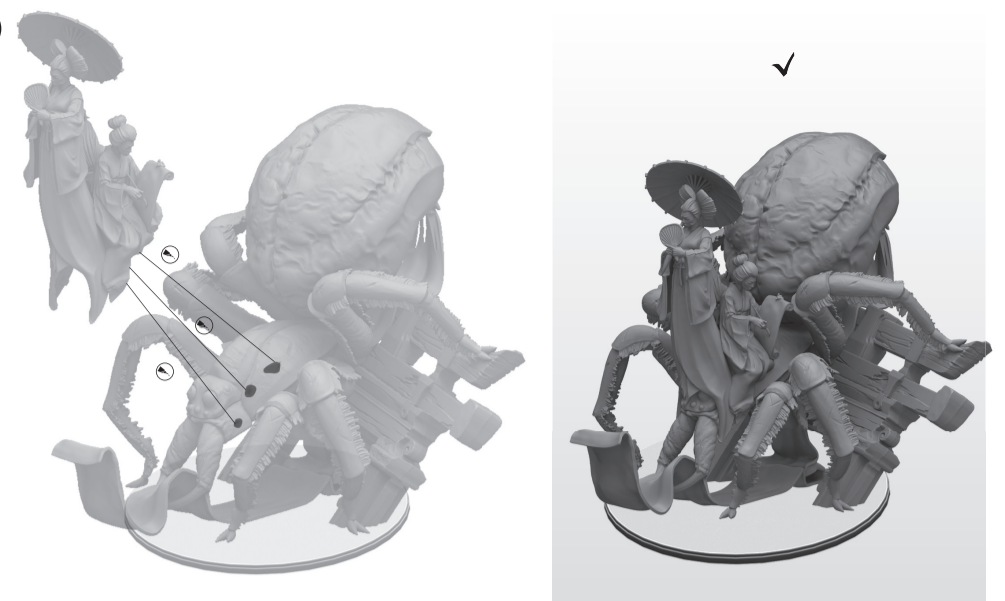

10

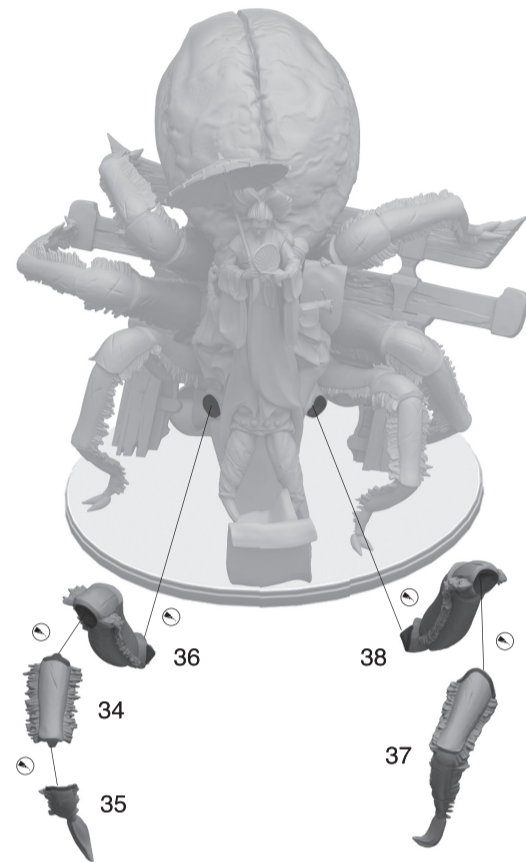

Jorogumo Mahotsu / Geisha Assembly Instructions

READ THIS FIRST

BEFORE ASSEMBLING YOUR MODEL KIT PLEASE READ THROUGH THE INSTRUCTIONS IN THIS BOOKLET CAREFULLY. A pair of plastic cutters is required to remove the plastic components in this kit from their frame. We advise to carefully scrape mould lines using a hobby knife. To assemble your model you will need plastic glue for plastic parts or super glue for resin parts.

SYMBOL EXPLANATION

- ⚠ Special Instruction - Please read
- 🚫 Do not glue the components
- 🔄 Rotate part
- ⚙ Variant assembly
- 🔍 Detail view
- 👉 Glue the component
- ✓ Stage complete
- 🔁 Repeat process

You will need:

 Plastic Glue	 Plier Cutters	 Hobby Knife	 Scan here: To find detailed instructions and the latest updates!
------------------	-------------------	-----------------	---

What you get:

20250417YONIJRGM41-A x1	20250417YONIJRGM41-B x1	20250417YONIJRGM41-C x1
--------------------------------	--------------------------------	--------------------------------

• Make sure to dry fit parts before gluing.

Jorogumo Mahotsu / Jorogumo Geisha

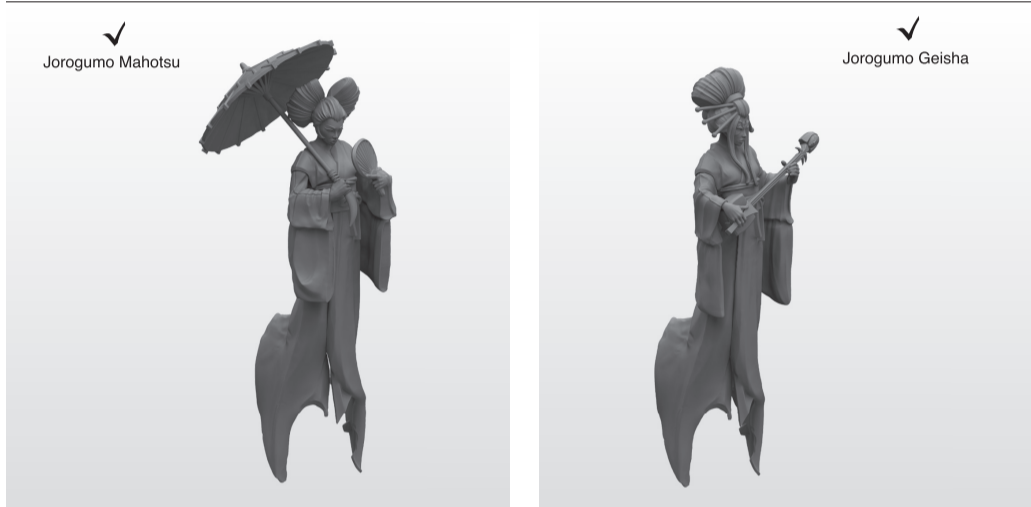
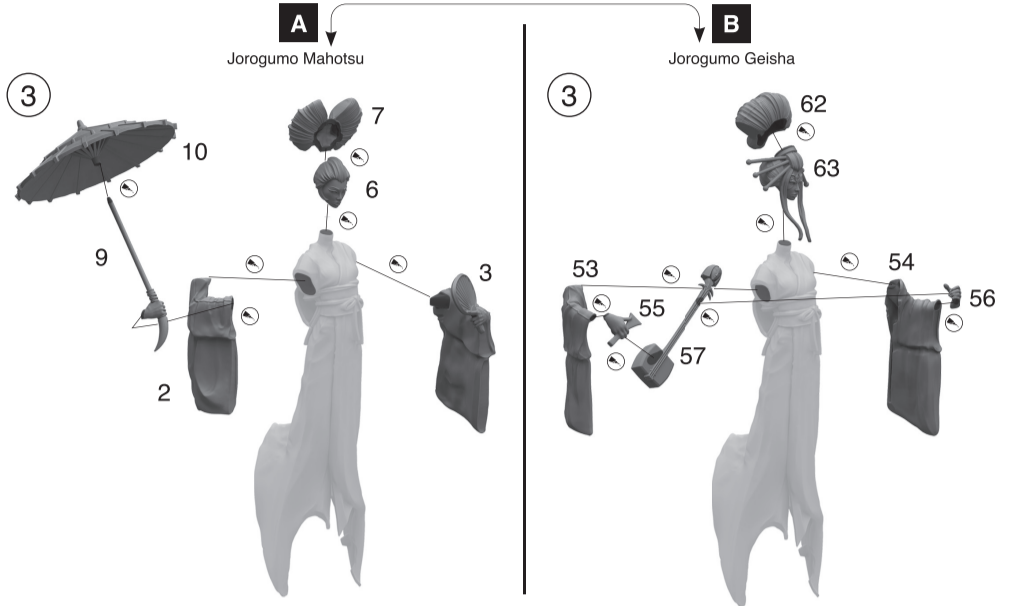
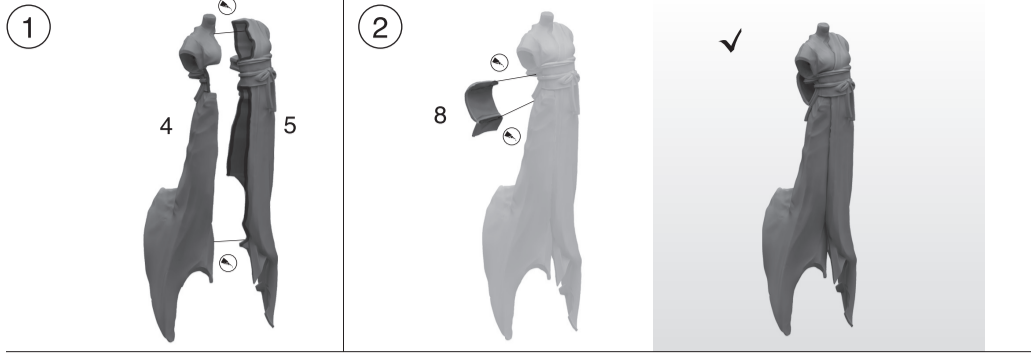

Musician - Variations

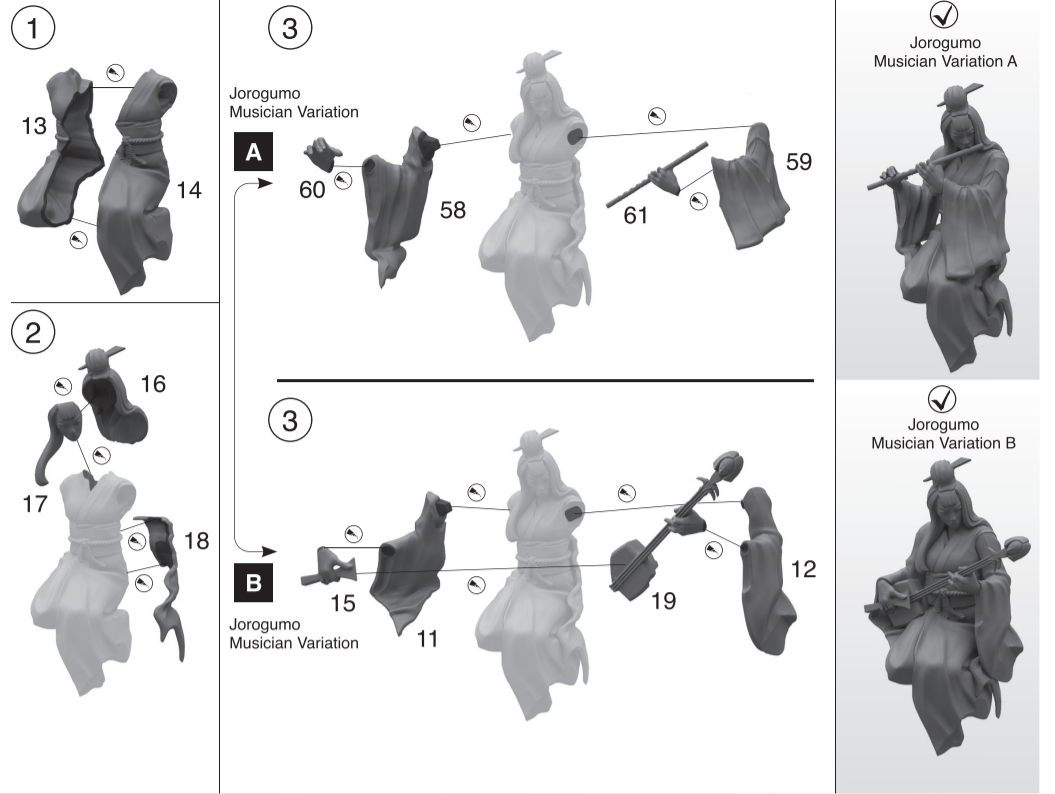

Scribe

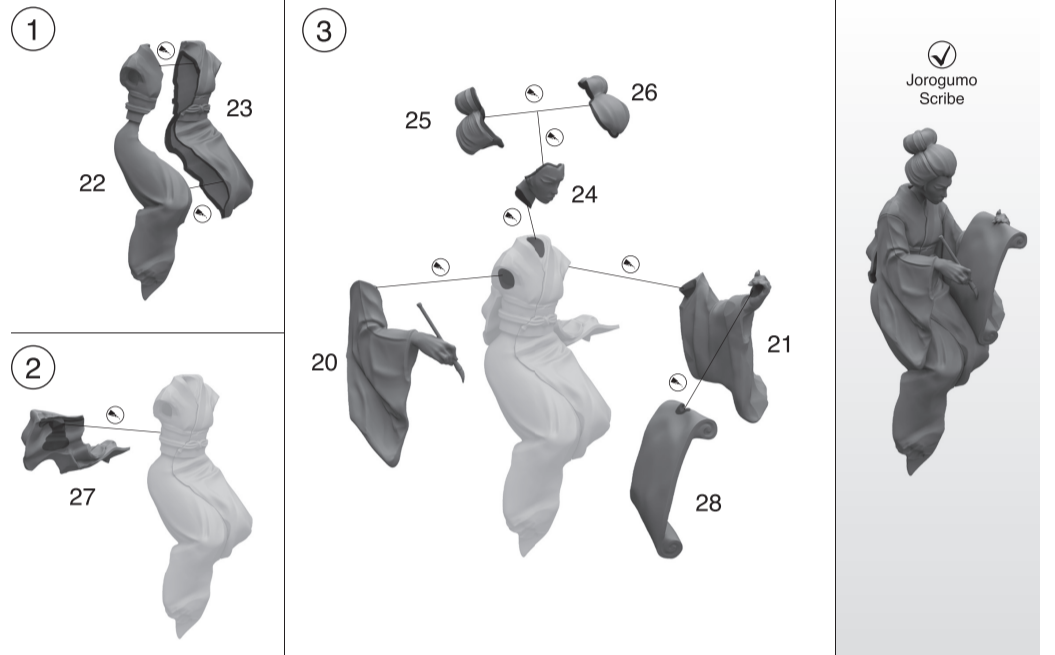

Jorogumo Helpers assembly

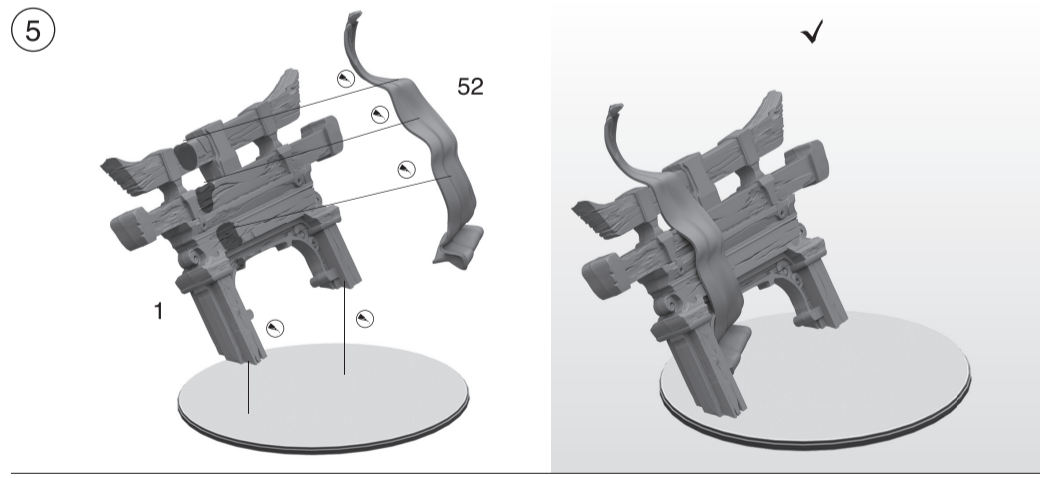
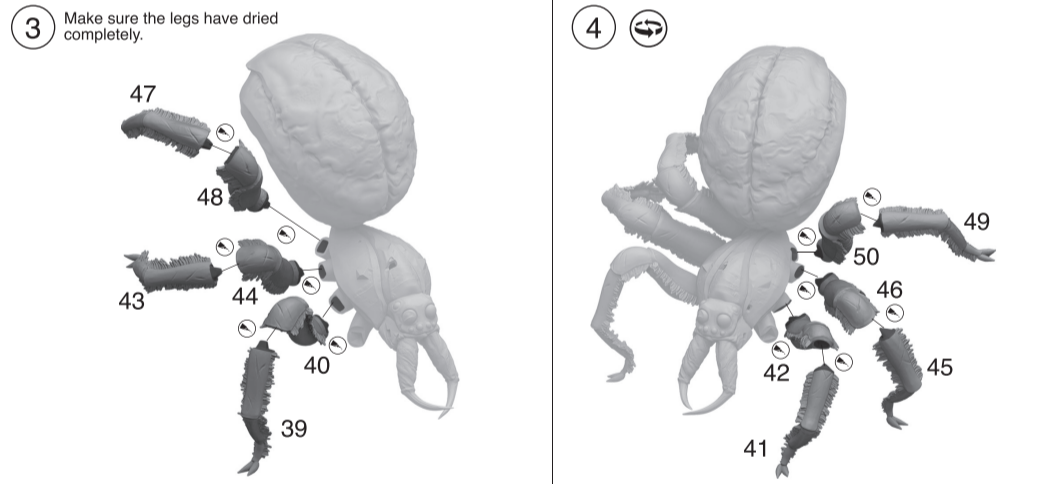
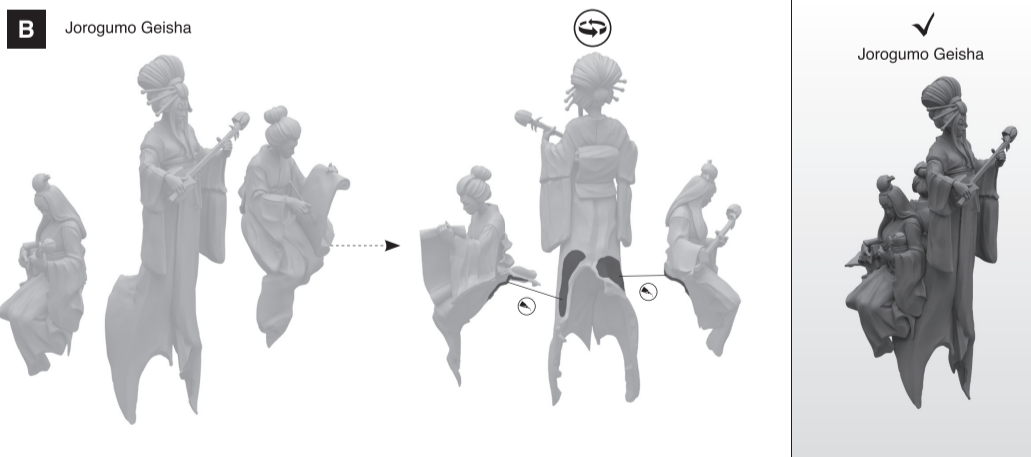
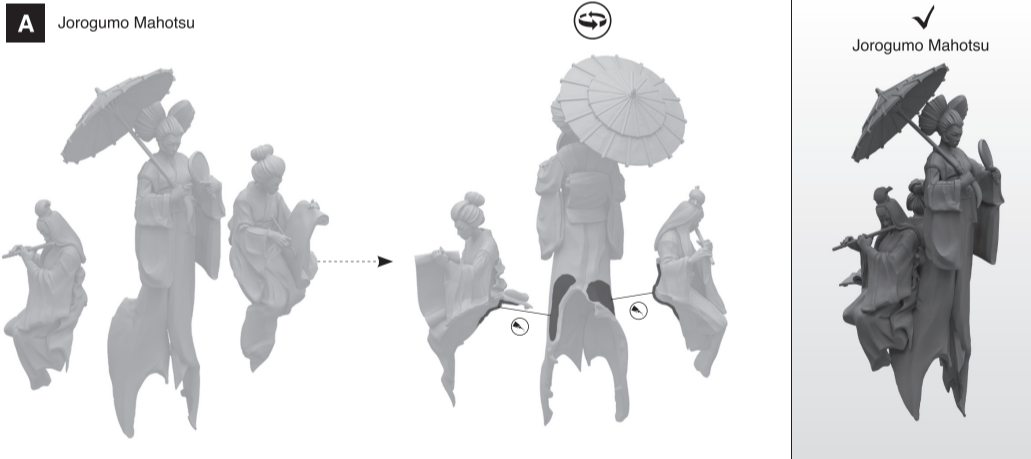

Spider Body

