

Incarnate Sentinels Assembly Instructions

• READ THIS FIRST - LIRE CECI EN PREMIER - LEA ESTO PRIMERO LESEN SIE DIES ZUERST - LEGGERE QUESTO PRIMO

BEFORE ASSEMBLING YOUR MODEL KIT PLEASE READ THROUGH THE INSTRUCTIONS IN THIS BOOKLET CAREFULLY. A pair of plastic cutters is required to remove the plastic components in this kit from their frame. We advise using a mouldline scraping to clean up the parts. To assemble your model you will need plastic glue.

AVANT D'ASSEMBLER VOTRE KIT DE MODÈLES, VEUILLEZ LIRE ATTENTIVEMENT LES INSTRUCTIONS DE CETTE BROCHURE. Une paire de couteaux en plastique est nécessaire pour retirer les composants en plastique de ce kit de leur cadre. Nous vous conseillons d'utiliser un ébarboir pour nettoyer les pièces. Pour assembler votre modèle, vous aurez besoin de colle plastique.

ANTES DE ENSAMBLAR SU KIT DE MINIATURAS, LEA CUIDADOSAMENTE LAS INSTRUCCIONES DE ESTE FOLLETO. Se requiere un par de cortadores de plástico para EXTRAER los componentes plásticos de este kit de su matriz.consejamos utilizar un kit de limpieza de líneas de molde para limpiar las piezas. Para ensamblar su miniatura, necesitará pegamento de plástico.

BEVOR SIE IHREN MODELLBAUSATZ ZUSAMMENBAUEN, LESEN SIE BITTE DIESE ANWEISUNGEN IN DIESER BROSCHÜRE SORGFÖLTIG. Ein Seidenschneider ist erforderlich, um die Plastikkomponenten aus diesem Bausatz und ihrem Rahmen zu entfernen. Wir empfehlen die Verwendung eines Gussgratentferner, um die Teile zu reinigen. Um Ihr Modell zusammenzubauen, benötigen Sie Kleber. Wir empfehlen Ihnen speziell für Plastikkomponenten Pastikkleber.

PRIMA DI ASSEMBLARE I TUOI MODELLI, LEGGI ATTENTAMENTE LE ISTRUZIONI CONTENUTE IN QUESTO OPUSCOLO. Per rimuovere i componenti di plastica dal telaio, sono necessarie un paio di taglierine per plastica. Si consiglia di utilizzare uno strumento per pulire le parti prima dell'assemblaggio. Per assemblare i tuo modelli avrai bisogno di colla per plastica.

• SYMBOL EXPLANATION • EXPLICATION DES SYMBOLES • EXPLICACIÓN DEL SÍMBOLOS • ERKLÄRUNG DER SYMBOLE • SPIEGAZIONE DEL SIMBOLO

 Special Instruction -Please read
Instruction spéciale -Veuillez lire
Instrucción especial -Por favor, lea
Spezielle Anweisung - Bitte lesen
Istruzioni speciali -Si prega di leggere

 Do not glue the components
Ne collez pas les composants
No pegue los componentes
Verkleben Sie die Komponenten nicht
Non incollare i componenti

 Rotate part
Faites pivoter la pièce
Girar parte
Teil drehen
Ruota la parte

 Variant assembly
Montage d'alternatives
Montaje de variante
Variante Montage
Assemblaggio variante

 Detail view
Vue détaillée
Vista detallada
Detailansicht
Visuale dettagliata

 Glue the components
Collez les composants
Pegue los componentes
Verkleben Sie die Komponenten
Incollare i componenti

 Stage complete
Étape terminée
Etapa completa
Phase abgeschlossen
Fase completa

 Repeat process
Répéter le processus
Repita el proceso
Vorgang wiederholen
Ripeti il processo

You will need / Vous avez besoin / Te hace falta / Sie benötigen / Avrai bisogno:



- Plastic Glue
Colle en plastique
Pegamento de plástico
Plastikkleber
Colla di plastica



- Plier Cutters
Pince latérale
Cortadores laterales
Seitenschneider
Frese laterali



- Precision Knife
Couteau de précision
Cuchillo de precisión
Präzisionsmesser
Coltello di precisione

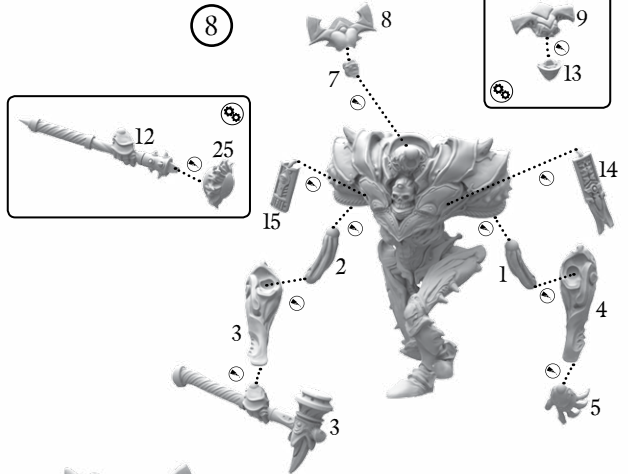
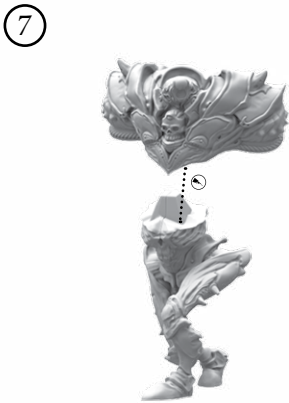
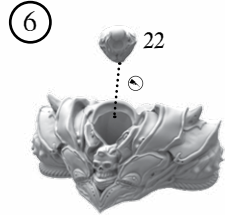
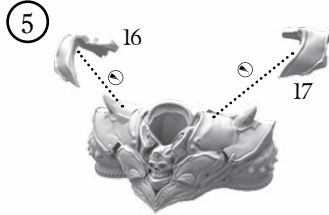
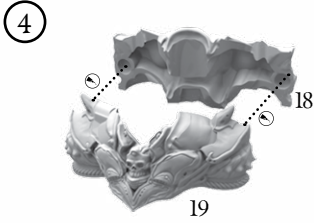
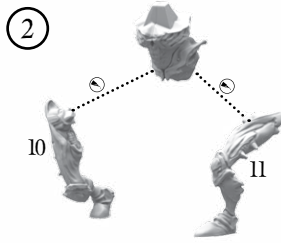
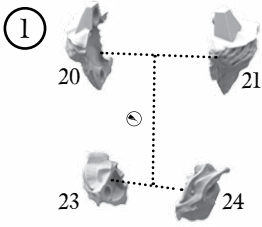

Heads, Hands and Arms are interchangeable in all poses.

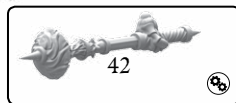
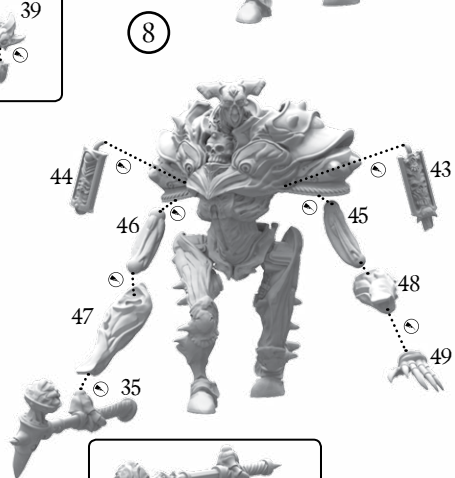
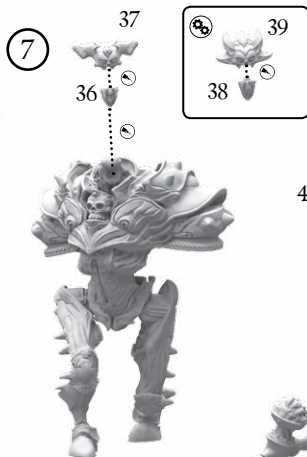
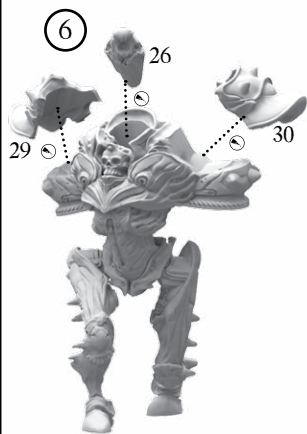
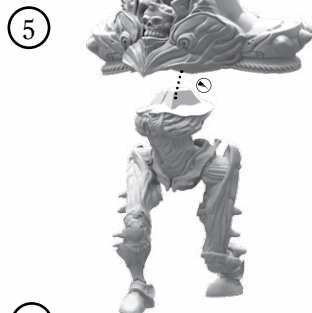
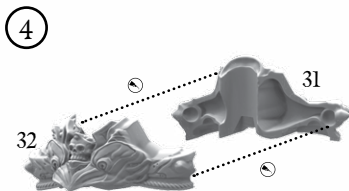
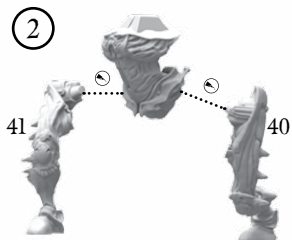
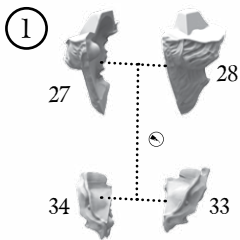

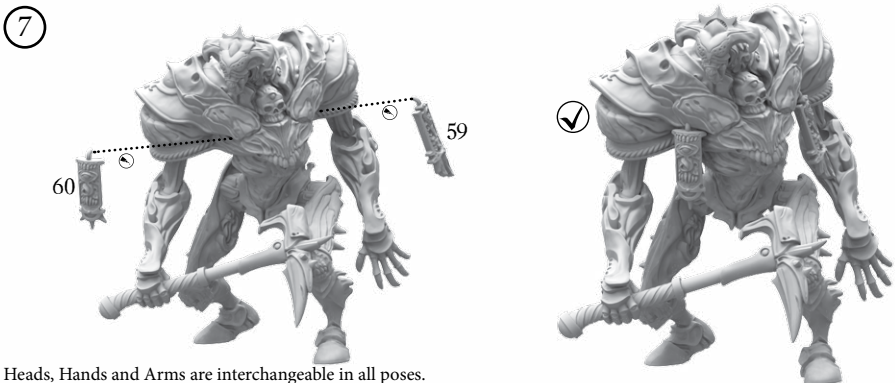
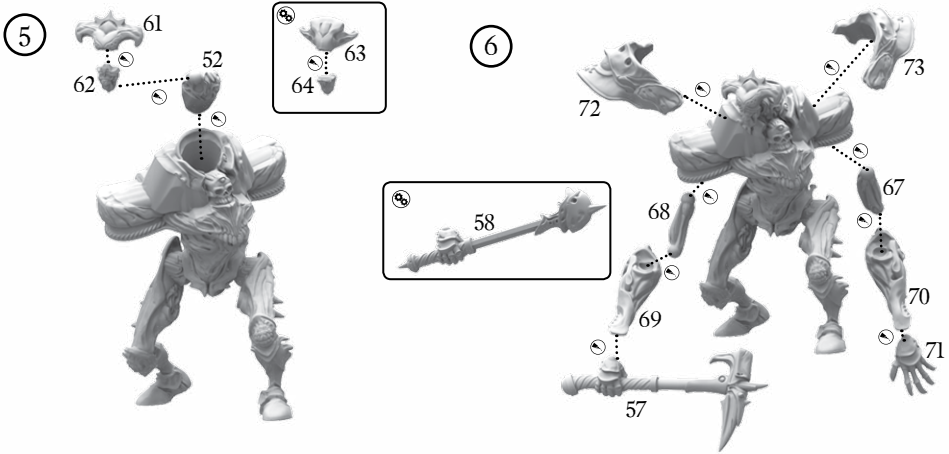
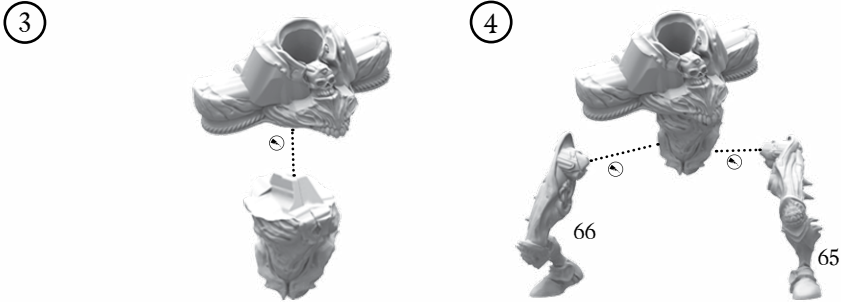
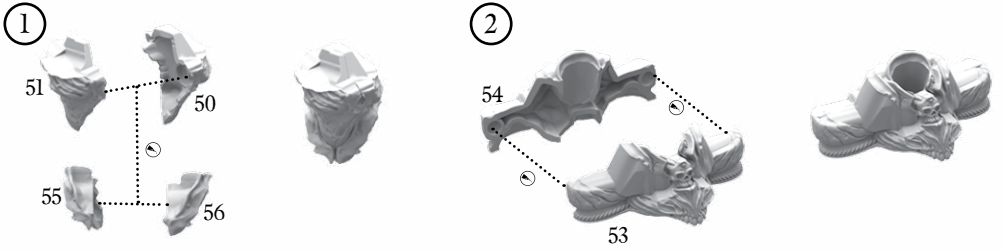

Heads, Hands and Arms are interchangeable in all poses.